

Vertical Clamps

IP10

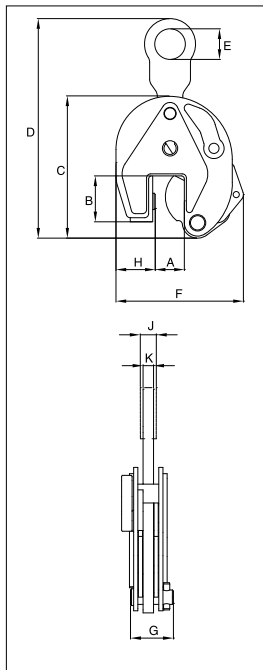

The IP10 vertical lifting clamp is used for the lifting, turning, moving or vertical transfer of sheet, plates, or fabrications from horizontal to vertical and down to horizontal (180°) as needed. Usually used as a single point pick or when used with a spreader beam with multiple vertical drop lines.



For Vertical Lifting, Turning and Transfer

- Available in capacities of .5 thru 30 metric tons (Higher Working Load Limits are available upon request).
- Wide variety of jaw openings available: 0 to 155mm.
- Welded alloy steel body for strength and smaller size. Forged alloy components, where required.
- Individually Proof Tested to 2 times the Working Load Limit with certification.
- Company name (CrosbyIP), logo, Working Load Limit and jaw opening permanently stamped on body.
- Each product is individually serialized, with the serial number and Proof Load test date stamped on body. Serial number is included on the test certificate with maintenance and warranty logbook.
- Available in a variety of styles:
 - IP10 - Standard clamp for materials with a surface hardness to 37Rc (345 HB).
 - IP10J - Larger jaw opening.
 - IP10S - For use with Stainless Steel material.
 - IP10H - For use with materials with a surface hardness to 47Rc (450 HB).
- Full 180° turning range for material transfer, turning or moving.
- Lock open, lock closed ability with latch for pretension on material and then release of material.
- Optional IP-5000 Stinger assembly available (see page 402). Allows for easy connection between the clamp and hoist hook.
- Minimum WLL of 10% of Maximum WLL.
- Maintenance replacement kits are available.
- Manufactured by a ISO 9001 facility.
- All sizes are **RFID EQUIPPED**.



Model IP10

Model	Working Load Limit (t)*	IP10 Stock No.	Weight Each (kg.)	Dimensions (mm)									
				Jaw A	B	C	D	E	F	G	H	J	K
IP10	0.5	2701674	1.8	0 - 16	44	128	207	30	115	41	28	-	10
IP10	1	2701662	2.2	0 - 20	45	139	215	30	126	41	38	-	10
IP10	2	2701676	7.6	0 - 35	78	201	336	70	190	61	55	-	16
IP10	3	2701664	13.8	0 - 40	100	253	436	75	225	78	60	-	20
IP10	4.5	2701666	15.0	0 - 40	100	253	436	75	232	82	65	-	20
IP10	6	2701668	23.5	0 - 50	126	302	515	80	292	84	95	40	20
IP10/J	6	2701705	28.5	50 - 100	126	302	515	80	342	84	95	40	20
IP10	9	2701670	27.5	0 - 50	126	325	550	80	310	92	105	44	25
IP10/J	9	2701672	28.5	50 - 100	126	325	555	80	360	92	105	44	25
IP10	12	2701678	49.0	0 - 54	160	391	580	80	331	117	137	41	25
IP10/J	12	2701680	58.0	54 - 108	178	439	630	80	415	117	137	41	25
IP10	16	2701682	68.0	5 - 64	178	465	690	88	397	119	153	49	25
IP10/J	16	2701684	90.0	64 - 128	208	521	746	88	472	119	161	49	25
IP10	22.5	2701686	108	5 - 80	222	554	800	110	470	136	186	49	25
IP10/J	22.5	2701688	110	80 - 155	253	628	880	110	575	136	196	49	25
IP10	30	2701690	148	5 - 80	222	545	800	110	470	152	186	54	30
IP10/J	30	2701692	152	80 - 155	250	620	880	110	565	152	196	54	30
For stainless steel - with fixed hoisting eye													
IP10/S	0.5	2702274	1.8	0 - 16	44	128	207	30	115	41	28	-	10
IP10/S	1	2702262	2.0	0 - 20	45	139	215	30	126	41	38	-	10
IP10/S	2	2702276	6.8	0 - 35	78	201	336	70	190	61	55	-	16
IP10/S	3	2702264	13.8	0 - 40	100	253	436	75	225	78	60	-	20
IP10/S	4.5	2702266	15.0	0 - 40	100	253	436	75	232	82	65	-	20
IP10/S	6	2702268	23.5	0 - 50	126	302	525	80	292	84	95	40	20
IP10/S	9	2702270	27.5	0 - 50	126	325	557	80	310	92	105	44	25
IP10/S	12	2702278	49.0	0 - 54	160	391	623	80	331	117	137	41	25
For very hard materials - with fixed hoisting eye													
IP10/H	0.5	2702174	1.8	0 - 16	44	128	207	30	115	41	28	-	10
IP10/H	1	2702176	6.8	0 - 35	78	201	336	70	190	61	55	-	10
IP10/H	2	2702164	13.8	0 - 40	100	253	436	75	225	78	60	-	16
IP10/H	3	2702166	15.0	0 - 40	100	253	436	75	232	82	65	-	20
IP10/H	4.5	2702168	23.5	0 - 50	126	302	515	80	292	84	95	40	20
IP10/H	6	2702170	27.5	0 - 50	126	325	550	80	310	92	105	44	25

* Design Factor based on EN 13155 and ASME B30.20.

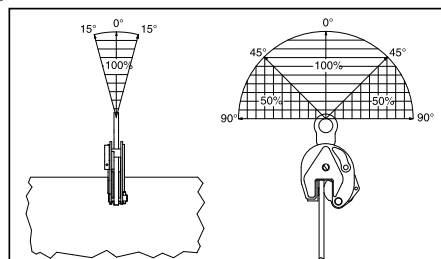

Crosby Lifting Clamps