

Shipbuilding Clamps: Bulbprofiles

Load Rated
IPBTO10



The IPBTO/10 shipbuilding clamp is used as a temporary tackle eye in spaces which have been reinforced with HP (bulb) profiles such as engine rooms and shipsections. This clamp is fitted with a screwed spindle for easy attachment of the clamp. The moment a load is applied, the clamp is automatically fixed.

For use as a temporary tackle eye in spaces which have been reinforced with HP (bulb) profiles such as engine rooms and shipsections.

- Available in capacities of 1.5 thru 6 metric tons.
- Wide variety of jaw openings available: HP 160mm to HP 430mm.
- Welded alloy steel body for strength and smaller size. Forged alloy components, where required.
- Individually Proof Tested to 2 times the Working Load Limit with certification.
- Company name (IP), logo, Working Load Limit and jaw opening permanently stamped on body.
- Each product is individually serialized, with the serial number and Proof Load test date stamped on body. Serial number is included on the test certificate with maintenance and warranty logbook.
- Maintenance replacement parts are available.
- Manufactured by a ISO 9001 facility.

Model IPBTO10

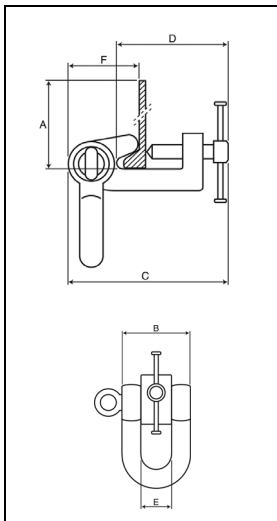

| Model | Working Load Limit (t)* | IPBTO10 Stock No. | Weight Each (kg.) | Dimensions (mm) | | | | | |
|---------|-------------------------|-------------------|-------------------|-----------------|-----|---------|---------|----|-----|
| | | | | Jaw A | B | C | D | E | F |
| IPBTO10 | 1.5 | 2700980 | 4.3 | HP 160-240 | 137 | 188-209 | 129-150 | 68 | 81 |
| IPBTO10 | 3 | 2700986 | 6.0 | HP 240-320 | 137 | 188-217 | 145-174 | 68 | 78 |
| IPBTO10 | 6 | 2700991 | 13.0 | HP 300-430 | 185 | 255-297 | 195-236 | 98 | 102 |

* Design Factor based on EN 13155 and ASME B30.20.