

Beam Clamps

Load Rated

IPTK



This IPTK series beam clamp is suitable for use as a temporary tackle eye for a beam.

For the Transfer of Steel Beams and Attachment of Tackle Eye

- Available in capacities of 2 thru 25 metric tons.
- Wide variety of jaw openings available: 75 to 1020mm.
- Welded alloy steel body for strength and smaller size. Forged alloy components, where required.
- Individually Proof Tested to 2 times the Working Load Limit with certification.
- Company name (IP), logo, Working Load Limit and jaw opening permanently stamped on body.
- Each product is individually serialized, with the serial number and Proof Load test date stamped on body. Serial number is included on the test certificate with maintenance and warranty logbook.
- Maintenance replacement parts are available.
- Manufactured by a ISO 9001 facility.
- All sizes are **RFID EQUIPPED**.

IPTKW



This IPTKW series beam clamp is suitable for use as a temporary tackle eye for a beam.

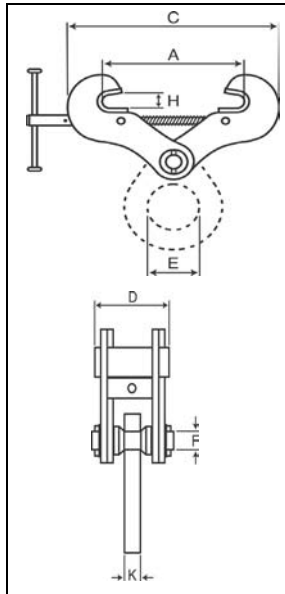

Model IPTK: with Hoisting Eye Model IPTKW: without Hoisting Eye

Model	Working Load Limit (t)*	Stock No.	Weight Each (kg.)	Dimensions (mm)						
				Jaw A	C	D	E	F	H	K
IPTK	2	2700996	6.0	75 - 190	A + 80	125	75	-	25	20
IPTK	3	2700997	6.5	75 - 190	A + 80	125	75	-	25	20
IPTK	4	2700998	8.5	150 - 280	A + 100	125	75	-	35	20
IPTK	5	2700994	11.0	120 - 350	A + 195	125	75	-	40	20
IPTK	10	2700970	31.0	300 - 500	A + 300	171	74	-	40	30
IPTK	25	2702999	225	450 - 1020	A + 220	500	125	-	76	45
Without Hoisting Eye										
IPTKW	2	2700966	4.0	75 - 190	A + 80	125	-	28	25	-
IPTKW	3	2700967	4.5	75 - 190	A + 80	125	-	28	25	-
IPTKW	4	2700968	6.3	150 - 280	A + 100	125	-	33	35	-
IPTKW	5	2700969	8.8	120 - 350	A + 195	125	-	33	40	-

* Design Factor based on EN 13155 and ASME B30.20.